

dcondo
hideaway

**ENJOY THE LIFE OF FREEDOM,
EVERYDAY**



 **SANSIRI**



DCONDO HIDEAWAY

Enjoy the life of freedom, everyday

What is your definition of freedom?

- ... Enjoy your solitude in an 8-rai (12,800 Sq.m.) green oasis
- ... Relax with everything you love, privately and socially
- ... Fulfill the fun lifestyle with leisurely jogging and cooking with fresh vegetables

If all this is YOU, then DCONDO is ready for you to touch the everyday freedom with the functional design to support every lifestyle that is YOU



fun day, everyday



PROJECT DETAILS

Location Chiangrak Road,
Klong Nueng Sub-District,
Klong Luang District,
Pathum Thani 12120

Land area Approximately 10 rai
(16,000 Sq.m.)

Common area Approximately 8 rai
(12,800 Sq.m.)

Unit type Studio 1 Bathroom 26 Sq.m.
1 Bedroom 1 Bathroom 32 Sq.m.
Total: 800 units

Project type Condominium; 3 buildings - 8 stories;
1 clubhouse building - 3 stories

Parking Approx. 320 Cars (40%),
32 Motorbike (10%)

Green area Approximately 2.5 rai (4000 Sq.m.)

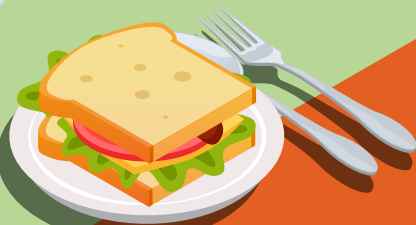
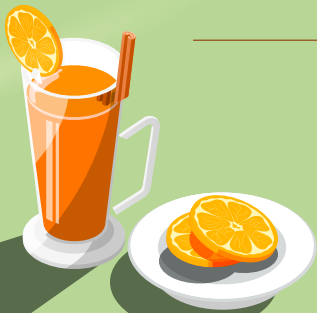



FACILITY HIGHLIGHTS

Enjoy the freedom lifestyle everyday



Freedom to relax

Jogging track for a leisurely exercise amidst great atmosphere

Freedom to good health

Organic vegetable garden to share with everyone

Freedom to unwind

Swimming pool surrounded by lush greenery

Freedom with amenities

Near the university, Red Line mass transit, hospitals, and posh shopping malls

FACILITIES



Clubhouse



Co-Working Area



Chilling Garden



Shuttle Service



LIV24



Swimming Pool & Private Pool



Fitness



Jogging Track



Urban Farm (Sansiri Backyard)



Parking Space

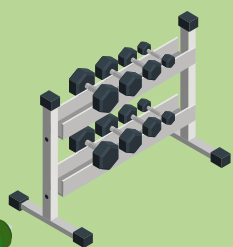



MASTER PLAN

Floor 1





MASTER PLAN

Floor 2 - 8

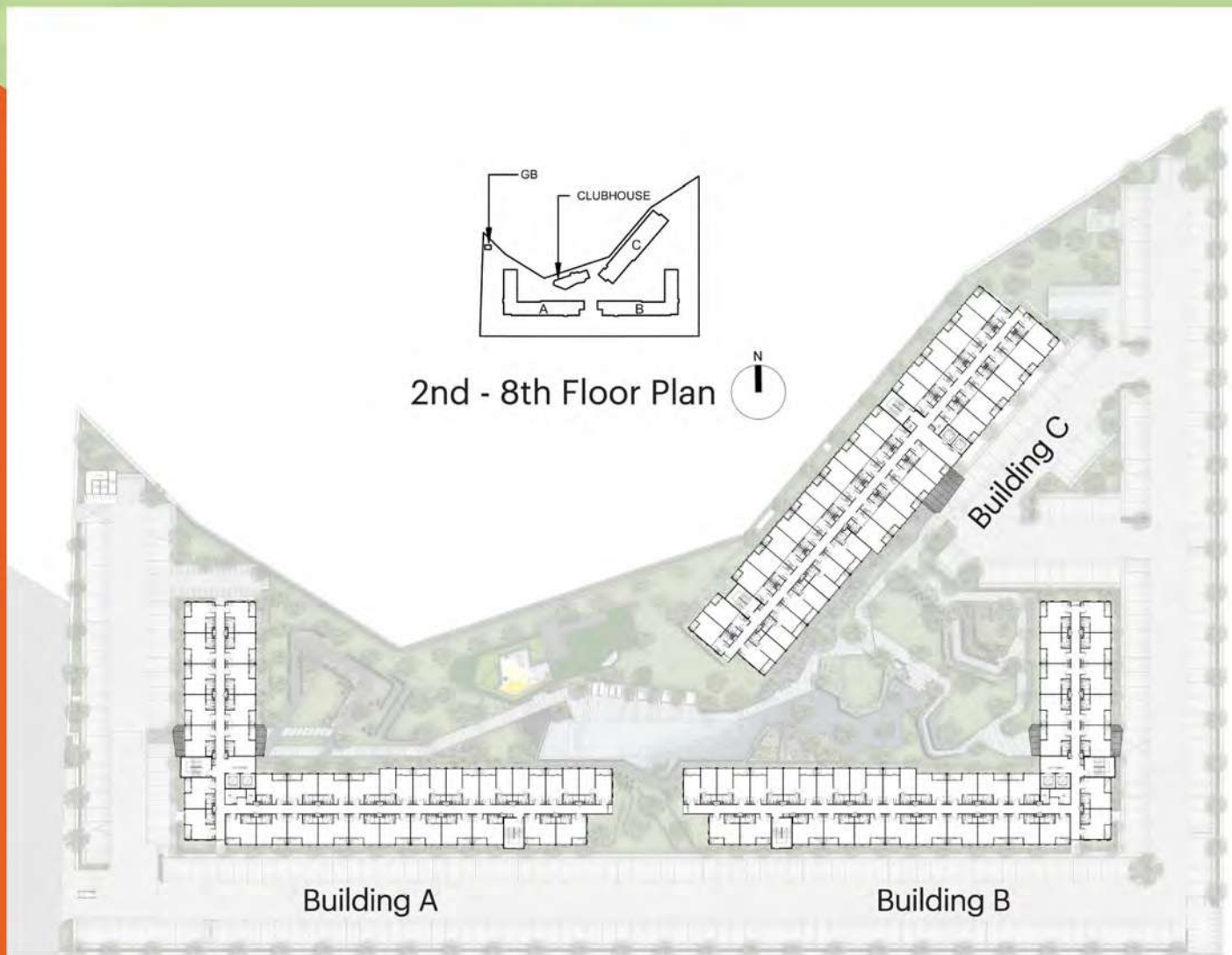

*Canopy is a 2nd floor feature only



FLOOR PLAN : BUILDING B

Floor 1

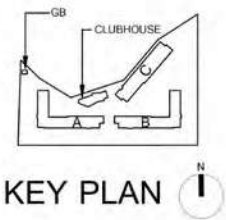
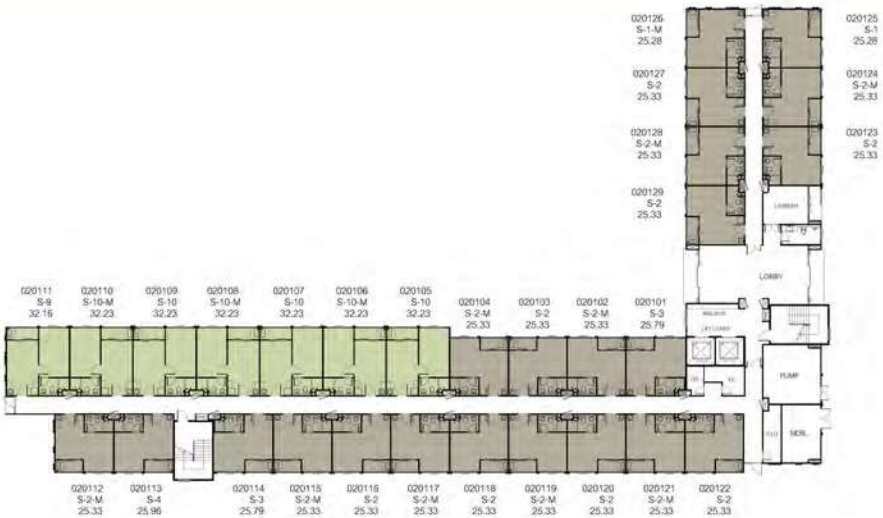

Floor 2 - 8



*Canopy is a 2nd floor feature only



ROOM LAYOUT



STUDIO TYPE-1
APPROX. 26 SQ.M.



STUDIO TYPE-2
APPROX. 26 SQ.M.



1 BEDROOM
APPROX. 32 SQ.M.



MAP

DCONDO HIDEAWAY

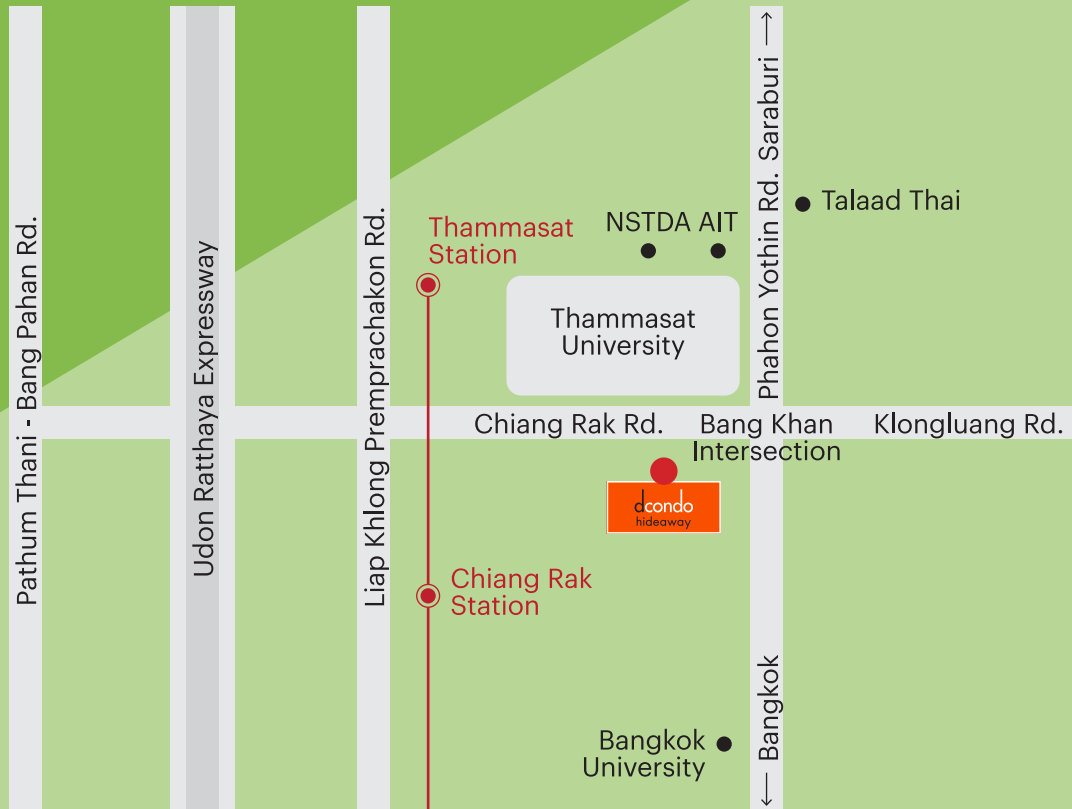

—●— The Red Line Mass Transit System Project (SRT)

Freedom... in every rhythm of life

Live your life, your way - on a location close to Thammasat University, Rangsit Campus

Be surrounded by a wide array of facilities and amenities, such as the future Red Line mass transit system, Udon Rattaya Expressway, shopping malls, hospitals, and leading educational institutions



**DCONDO
HIDEAWAY**

1 KM.
Thammasat

4 KM.
Bangkok
University

7 KM.
NSTDA

10 KM.
Future Park/
Talaad Thai





 SANSIRI

sansirithailand.cn

Project Owner : Sansiri PLC Company's registered no. 0107538000665. Head office : 59 Rim Khlong Phra Khanong, Phra Khanong Nuea Sub-District, Watthana District, Bangkok 10110. Registered capital (THB): 16,224,125,722.40, Paid up capital(THB): 15,903,125,722.40 (as of date 9 June 2020). The President : Mr. Srettha Thavisin. The Project : dcondo hideaway, Land title deed no. 198640, approximately area 10 Rai, Located at, Klong Neung, Klong Luang, Pathum Thani, as a Condominium of 8 storey(ies), 3 building(s), total of 800 unit(s), (for residential: 800 units, and for commercial: - units). The Land and building have been mortgaged with CIMB Thai Bank PLC., in the process to submit the building permission. Construction will be started in Oct 2020 and expected to be completed in Dec 2021 which will later be registered as the condominium. The unit owner shall pay sinking fund, common fee, tax and other fees as prescribed by the Project Owner or the Condominium Juristic Person subjected to the Condominium law.